



Installation Guide

For Smoke Sensor Wi-Fi LH-601WF

Welcome!

This guide will walk you through the installation of the Smoke Sensor Wi-Fi.

Start enjoying your smart home experience today!

Content

In The Box	2
Appearance	3
Install Smoke Sensor Wi-Fi	4
Set up Smoke Sensor Wi-Fi	8

In The Box

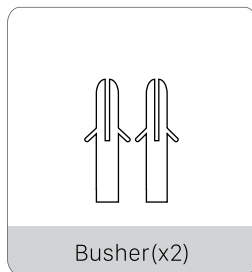
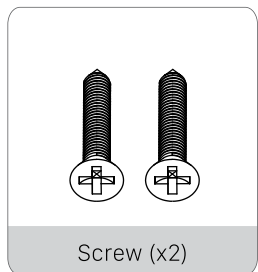
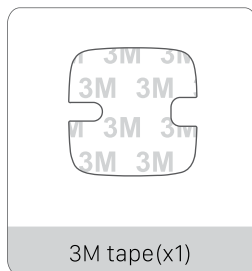

Appearance

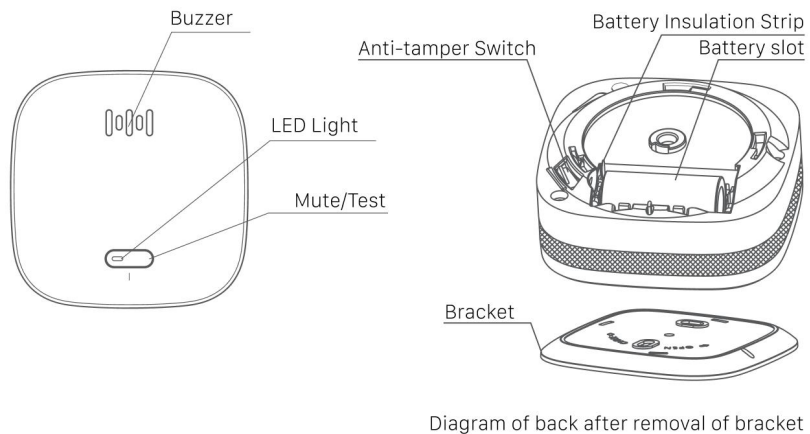

Install Smoke Sensor Wi-Fi

Install Indoors Only: Mount the product on indoor ceilings only.

Corridor Placement: Install one in each corridor outside bedrooms; install additional units in corridors facing multiple bedrooms.

Coverage for Long Areas: Install one unit at each end of corridors or rooms longer than 12 meters.

Multiple Floors: Install a unit on each floor, including lofts and basements.

Avoid Obstructions: Keep the unit at least 50 cm away from lamps or decorations and 15-30 cm from corners.

Slanted Ceilings: Install the unit 90 cm away from the top if the ceiling is slanted.

Note: The grey area is not recommended to install.

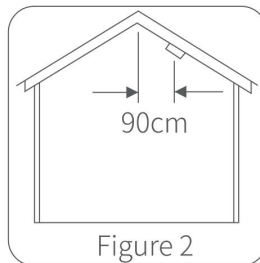
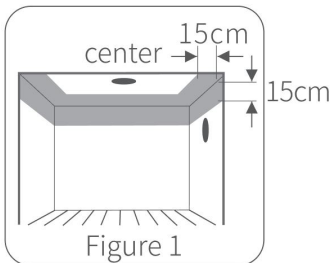

Note: Use screws for installation to prevent accidents; adhesive methods are less secure.

Installation Instruction I

1. **Marking and Drilling:** At the selected installation spot on the ceiling or wall, mark the center points of the two holes on the bracket. Drill holes at these marks using the appropriate drill bit, then insert the roll plugs until they are flush with the surface of the ceiling or wall. (Note: Keep the sensor away from dust during drilling).
2. **Bracket Installation:** Use the two screws provided in the accessories bag to securely attach the bracket to the ceiling or wall.

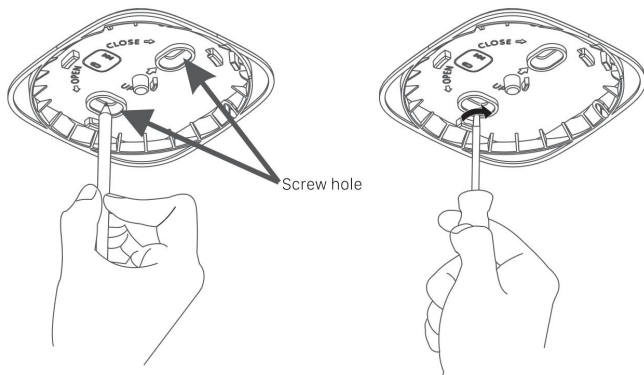

3. Align the body of the product with the "Product Installation Icon" marked on the bracket. Gently rotate the product body clockwise until you hear a distinct "click" sound. This confirms that the product is securely locked into the bracket.

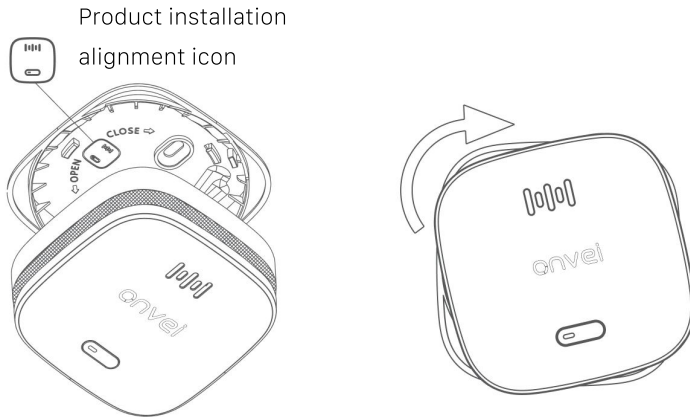

Installation Instruction II

1. Prepare the 3M Tape: Begin by removing the protective film from one side of the 3M tape.
2. Attach Tape to Bracket: Affix the exposed side of the 3M tape securely to the back of the bracket, ensuring it is aligned properly and covers the area evenly.
3. Position on Ceiling: Once the tape is in place, remove the protective film from the other side of the 3M tape. Carefully position the bracket against the ceiling where you want to install the product. Press firmly for 30 seconds to ensure strong adhesion.

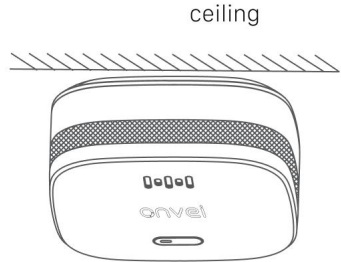
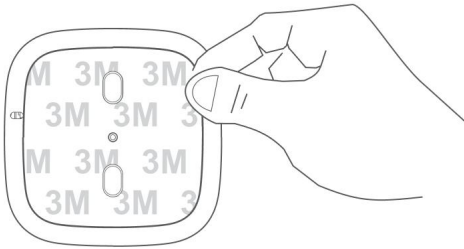

① Set up Smoke Sensor Wi-Fi

To control the Smoke Sensor Wi-Fi with a mobile device, install the Smart Life app. You can download the Smart Life app here.



② Add Smoke Sensor Wi-Fi

1. Open the app to create a new account or log in.
2. Press and hold the Smoke Sensor Wi-Fi button for 12 seconds. The sensor will enter configuration mode.
3. In the app, tap the "+" icon and select "Add Device".

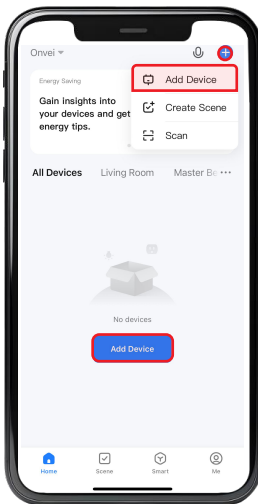

4. Navigate to the "Sensors" category and choose "Smoke Detector Wi-Fi".

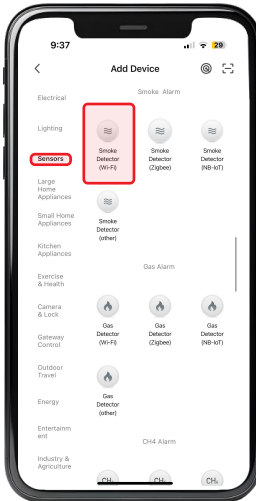

5. Choose your Wi-Fi network name and enter its password. Then, click on "Next".

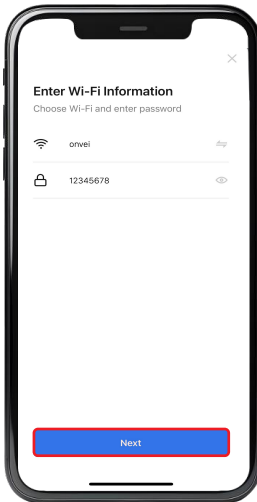

6. Press and hold the "Mute/Test" button for 12 seconds to allow the device to enter pairing mode. The green LED will then flash rapidly.

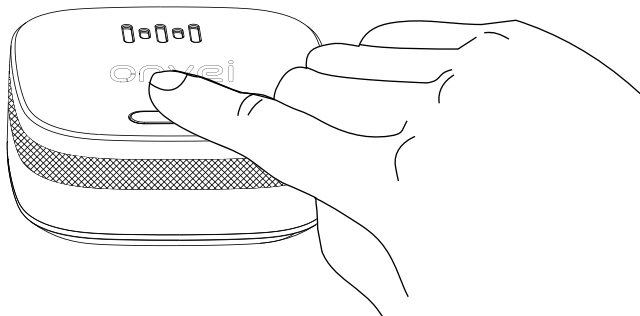

7. Select "Confirm the indicator is blinking".

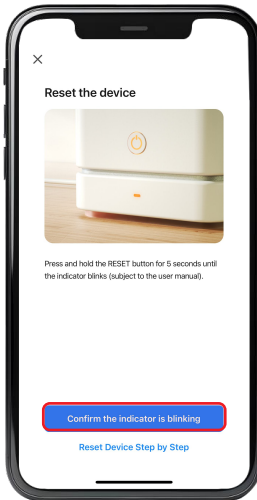

8. Select "Blink Slowly".

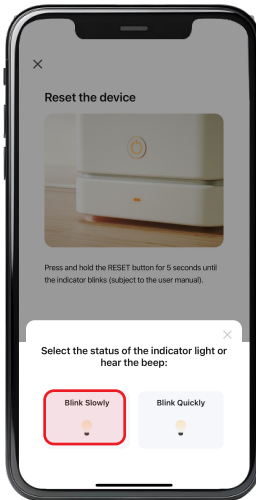

9. Select "Go To Connect".

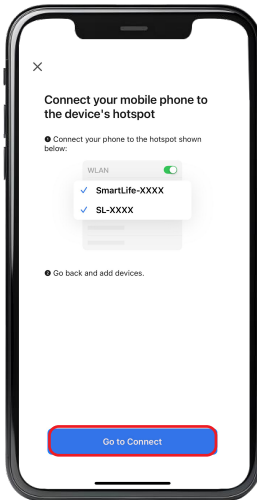

10. Open the Wi-Fi settings on your device.
11. Search for the network named after the product, typically labeled as "Smart Life".
12. Select this network to connect.

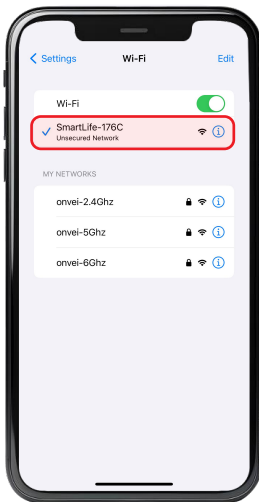

Note: Ensure you are within a suitable range of the device to establish a stable connection.

13. Wait for the app to detect and initialize the device.
14. After the device is detected and its name appears, click "Done".

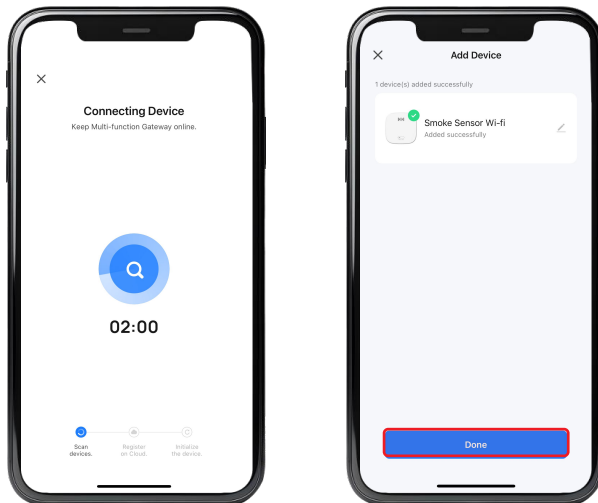

Congratulations!

Your Smoke Sensor Wi-Fi installation is complete.

Start Enjoying Your Smart Home Experience Today!

onvei.com